

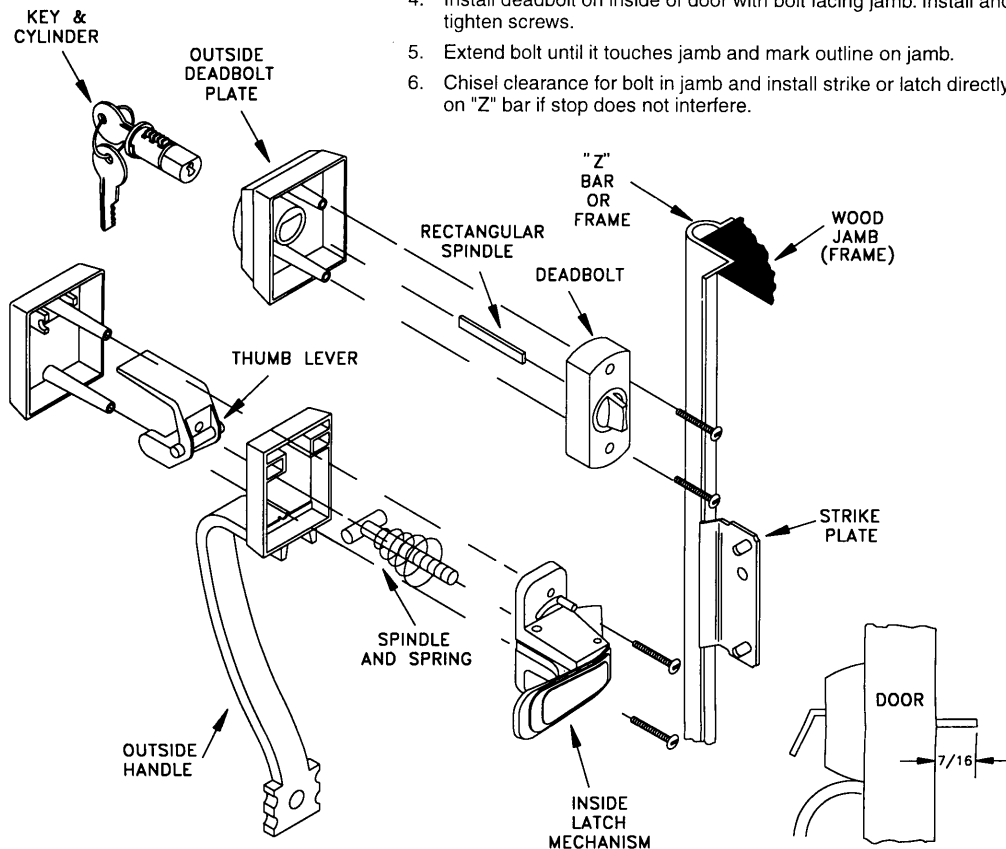

DEADBOLT MOUNTING

1. Assemble the key and cylinder to the outside deadbolt plate by inserting the key and cylinder into the plate and turning the key one half turn. Remove key from cylinder prior to further installation.
2. Assemble rectangular spindle to outside deadbolt assembly.
3. Insert outside deadbolt assembly with spindle from outside of door; mark and cut spindle to extend approximately 5/16" above surface of door and shims, if supplied.
4. Install deadbolt on inside of door with bolt facing jamb. Install and tighten screws.
5. Extend bolt until it touches jamb and mark outline on jamb.
6. Chisel clearance for bolt in jamb and install strike or latch directly on "Z" bar if stop does not interfere.



HANDLE MOUNTING

1. Assemble outside handle with thumb lever, spindle, and spring. Push this assembly through installation holes from outside of door.
2. Without depressing lever, spindle must project through door approximately 7/16". If too long, saw or break off to length specified above.
3. Depress lever to extend spindle. Position latch mechanism over holes, guiding spindle into slot in center of mechanism. Insert both machine screws into threaded sleeves and screw each down to a snug position—then draw up firmly.
4. Install strike plate on wood jamb or aluminum "Z" bar to firmly engage latch bolt.
5. Use 3/32" drill for lower handle hole—drill through outside of door only and securely fasten with screw provided.

95340-000
REV A